

Crash Bar Bag User Manual

Model: BHGB◆◆T

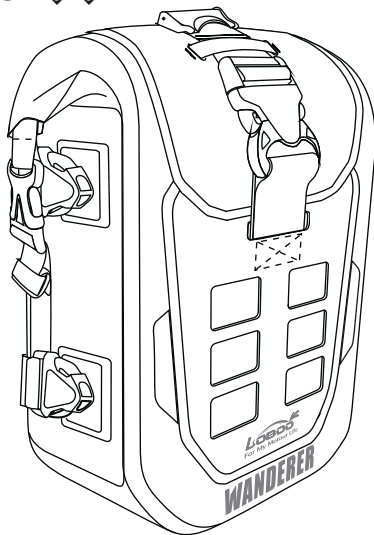

Please read the manual and related after-sales service terms carefully before use. Incorrect installation and use can damage the product, significantly affect safe driving, and lose related free warranty services.



Scan QR Code To Watch
The Installation Video

Parameter

Model: BHGB11T



Capacity: 6 L/Per bag

Dimensions: Length 250mm/9.84in* Width 120mm/4.72in* Height 300mm/11.81in

Material: TPU, Nylon, PVC, POM

Compatible crash bar: rectangle, triangle, multi-bar irregular crash bar

Accessories List

Serial Number	Name	Diagram	Quantity	Remarks
①	crash bar bag		2 pcs	Left bag 1 pc Right bag 1 pc
②	U-shaped support plate		2 pcs	

Product Details

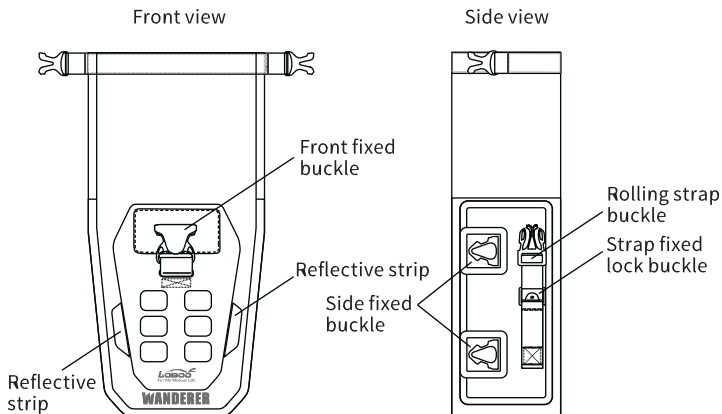

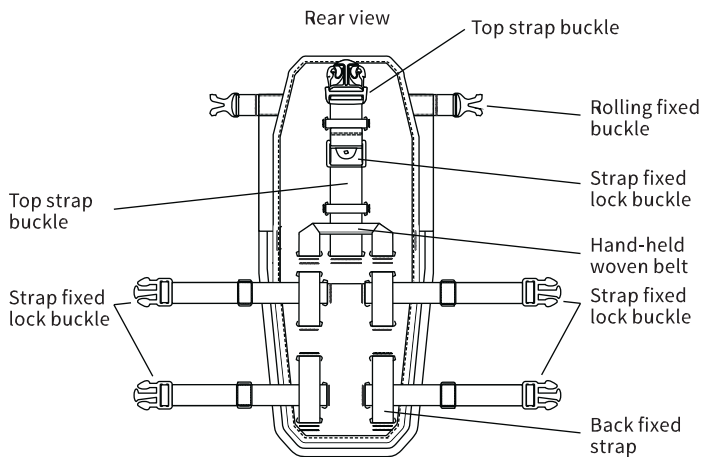

Installation Diagram

1. Put part ② into part ①, and insert both ends into the fixed positions on both sides.

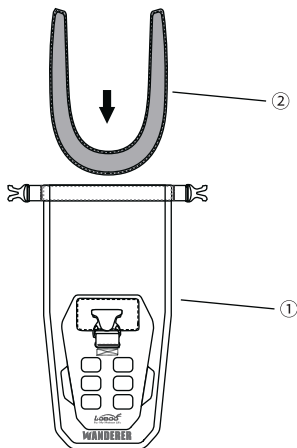

Part ① Internal Diagram

Support plate

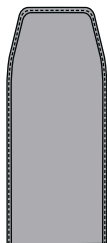

+

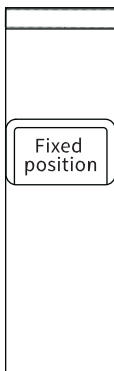

=

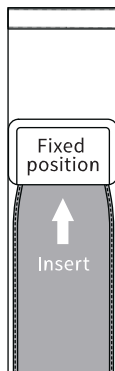

2. Put the items into part ①, press down, and roll the bag mouth back three circles.

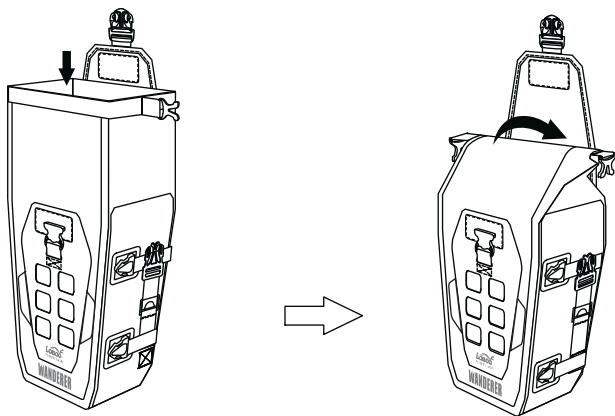

3. Fasten the fixed buckle at both ends of the bag mouth of part ① with the rolling strap buckle on both sides of part ①, adjust the length of the strap to fasten the strap fixed lock buckle. Cover the top bag cover, fasten the top buckle, adjust the side strap length to fasten the strap fixed lock buckle.

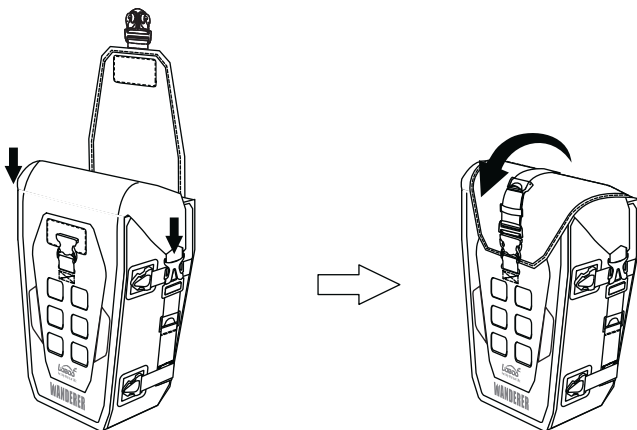

Installation Diagram

1. According to different crash bar, choose the most suitable top fixed position. Use the top strap buckle of the bag, pass through the crash bar from the inside to the outside, then pass through the top fixed strap channel and the hand-held strap, and fasten with the fixed buckle in front of the guardrail bag, adjust the length of the top strap to fasten the strap fixed lock buckle, and the top installation completed.

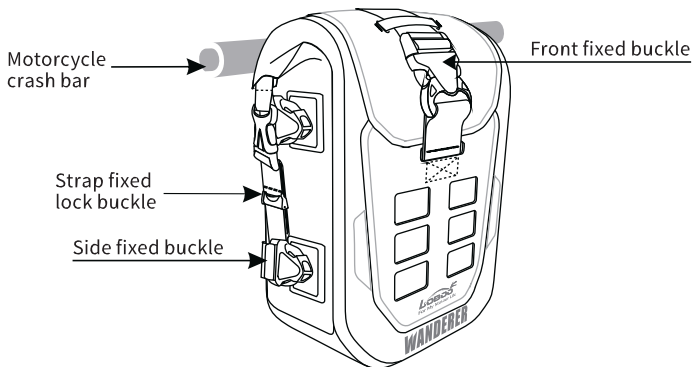
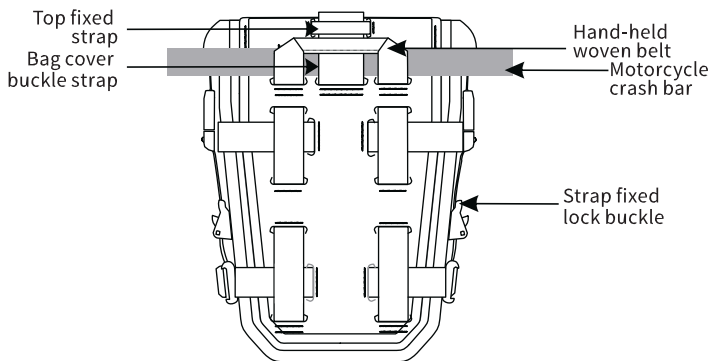

2. According to different motorcycle crash bar, choose the most suitable fixed position on both sides, use the side strap buckle of the bag, pass through the back fixed strap, pass through the crash bar from the inside to the outside, and fasten with the side fixed buckle of the bag (or first pass through the crash bar, then pass through the back fixed strap. According to the width of the motorcycle crash bar, choose the most suitable fixed position), adjust the length of the strap storage tape and stick the magic tape, and the installation on both sides can be completed.

Motorcycle crash bar 1

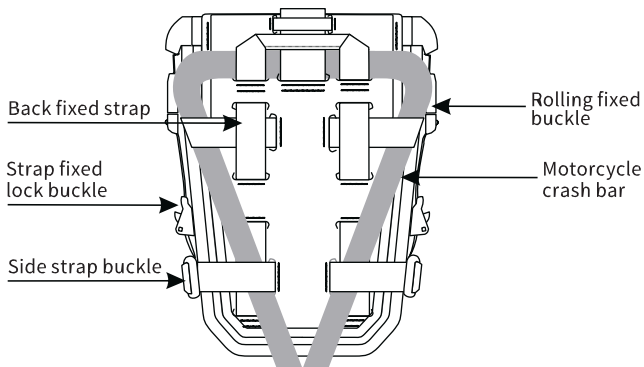

Motorcycle crash bar 2

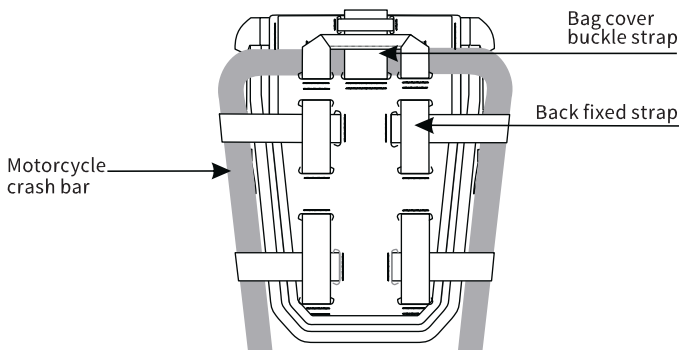

Warranty Card



Please read this after-sales service guarantee card carefully. If you cannot accept it, please contact the dealer for return and exchange in time. Installation and use means acceptance of this after-sales service term.

After-sales Service Terms

1. One-year free warranty period, this product can enjoy free repair service within one year from the date of sale if there are quality problems under normal circumstances.
2. Limited warranty: After the one-year warranty period expires, LOBOO will provide paid warranty service, the cost is based on the actual replacement material cost, and no labor cost is charged separately.

Free warranty service does not include the following

1. No warranty card or cannot provide valid purchase proof.
2. Improper installation, use, man-made or accidental damage, self-disassembly, self-modification and repair, etc.

Return and Exchange Information

Platform ID: _____ Order Number: _____

Contact Name: _____ Contact Phone: _____

Return Address: _____

Discription

Please keep this card properly and send it back with the product (copy is valid)