

LOBOO
For My Motour Life

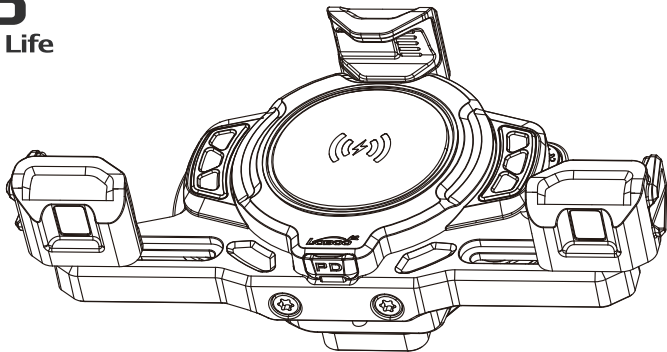

PH02

Phone Holder

User Manual

Please read the manual carefully before use. Wrong installation and use methods may cause the mobile phone to fall off the phone holder or damage the phone holder, and lose related after-sales services.

Product Specifications

Model: PH02

Compatible Phone Size (Including Phone Cases)

Width Range: 65–98mm/2.56–3.86in Length Range: 125–170mm/4.92–6.69in Thickness Range: ≤13mm/0.51in

Input Voltage: 12–16V

Wireless Charging Output Power: 15W(MAX)

Wired Charging Output Power: 36W(MAX)

Protection Features: Reverse Connection Protection / Short Circuit Protection / Overvoltage Protection /
Overcurrent Protection / Overcharge Protection / Undervoltage Protection / Over-
temperature Protection / Foreign Object Detection Protection

Vibration Damping Structure: Multiple vibration dampening

Packing List

①



Quantity: 1 piece

13mm Phone Holder

②

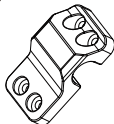

Quantity: 1 piece

13mm Clamp Liner

③

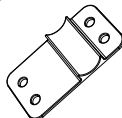

Quantity: 1 piece

Clamp Padding

④



Quantity: 4 pieces

M4x18

⑤



Quantity: 1 piece

3mm Hex Wrench

⑥



Quantity: 1 piece

Screw Glue

⑦

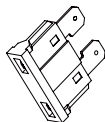

Quantity: 1 piece

Spare Fuse (10A)
(For wireless
charging model)

⑧

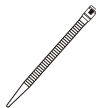

Quantity: 8 pieces

Cable Ties (For wireless
charging model)

Product Diagram

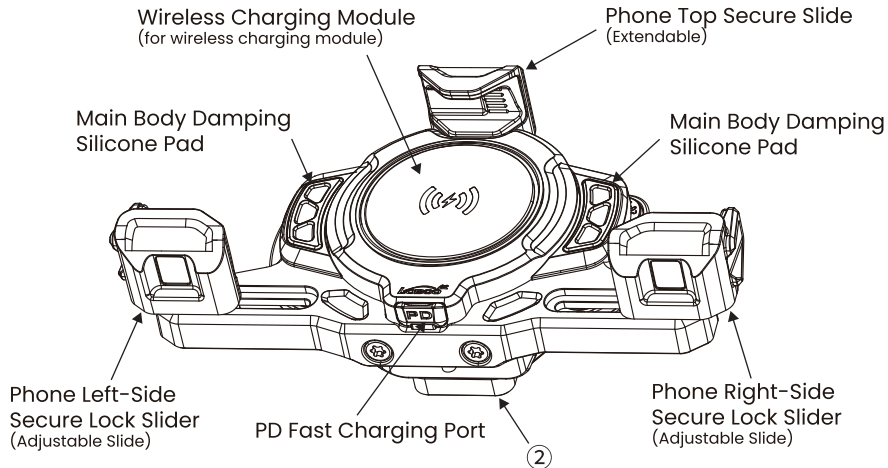

Product Diagram

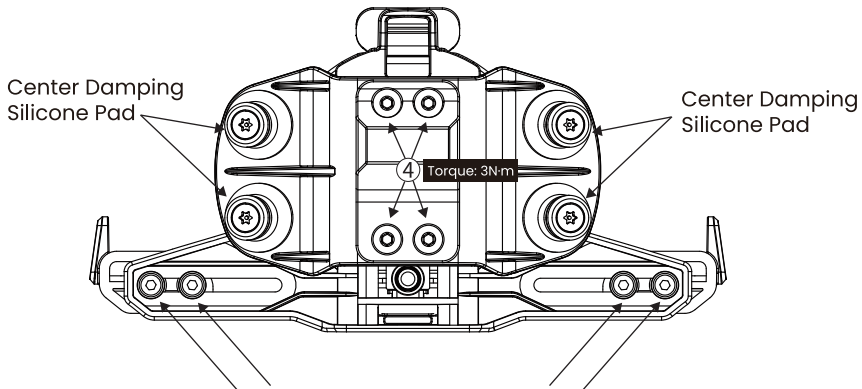

Adjustment Screws for Phone Left and Right Secure Lock Sliders
(Loosen the screws and slide the left and right sliders to the appropriate position. The positions of the left and right sliders must be symmetrical. The screw torque is 1.5N·m. Please note that the screw threads need to be coated with screw glue.)

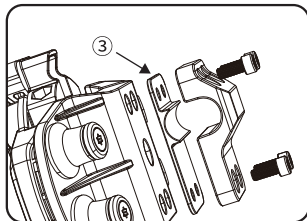

Wireless Charging Module Wiring Diagram

Fuse Box

10A

" + " Symbol, Connect Red Wire to Positive Terminal

" ACC " Symbol, Connect Yellow Wire to ACC

" - " Symbol, Connect Black Wire to Negative Terminal

ACC refers to the 12-15v wire on a motorcycle that energizes when the key is turned on and cuts off when the key is turned off.

Installation and Usage, ACC Detection Video



Scan QR Code to Watch Video

Installation Diagram

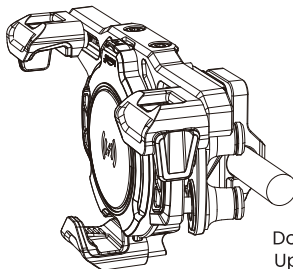
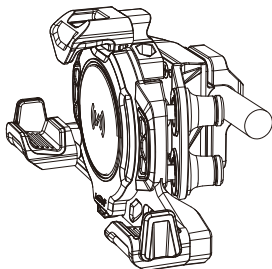

Do Not Install
Upside Down

Usage

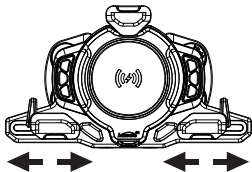

1. Please use the provided wrench to adjust the positions of the left and right secure lock sliders according to the size of your phone. (Note: Before adjusting, unscrew the adjustment screws, apply screw glue to the threads, and tighten according to torque requirements after adjustment.)

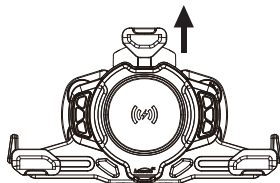

2. After adjustment, extend the top secure lock slider.

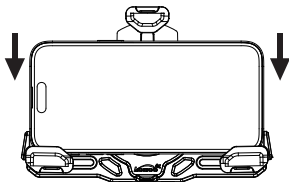

3. Place your phone into the mount.

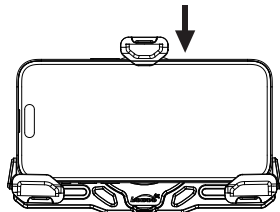

4. Once the left and right secure lock sliders are snug against the phone, release them and let the top secure lock reset and securely fasten the phone in place.

Notes

1. This motorcycle phone holder is designed for daily riding use only. It is strictly prohibited to use it excessively for activities such as jumping, racing, high-intensity off-roading, etc.
2. Please adjust the positions of the left and right secure lock sliders correctly. The gap between the left and right secure lock and the phone should not exceed 0.5mm/0.02in. Incorrect adjustment can cause the phone to detach and fall from the mount.
3. When changing to a phone of a different model or size, readjust the positions of the left and right secure lock sliders as well as the top secure lock.
4. Regularly inspect all screws and tighten them promptly if any looseness is observed.
5. Periodically check the smoothness of the top slider to prevent dust or other foreign objects from causing jamming. If this occurs, remove the top slider screw, clean it (including the holes), apply a suitable amount of lubricant on the screw's surface and gasket, and reassemble after applying threadlocking adhesive. Screw torque: 1N·m.
6. To ensure optimal wireless charging performance, when placing the phone, please ensure that the back of the phone is as close as possible to the phone holder. It is recommended to use thin phone cases. The farther the phone's back is from the wireless charging module, the lower the charging efficiency will be, with a maximum distance of approximately 3mm/0.12in.

7. Do not use phone cases with metal components on the back, as this can trigger the foreign object detection protection function of the wireless charging module, causing charging to stop.
8. When installing the phone holder's cable, route the wiring to avoid the vehicle's ignition coil and high-voltage package to prevent electromagnetic interference that might result in abnormal wireless charging operation.
9. Smartphones come with intelligent temperature control systems. When the external environment temperature is high, there is direct sunlight, poor phone heat dissipation, or excessive charging power causing the phone's temperature to rise, the wireless charging may automatically reduce its power output. This is particularly noticeable with Apple phones, where the temperature control threshold is relatively low. High temperatures may lead to slower charging rates or even charging while discharging. Normal charging will resume once the phone's temperature decreases. For rapid charging, please use the wired charging feature of the phone holder.
10. Phone holder with charging capabilities are only suitable for installation on fuel motorcycles with a DC voltage of 12-16V. Do not use beyond this range.
11. When not using wired charging, please keep the charging port's silicone plug in the closed state.

After-Sales Service Terms

1. **1-Year Free Warranty Period:** This motorcycle phone holder is eligible for a 1-year free warranty period starting from the date of purchase. In the case of quality issues arising under normal usage conditions within this period, you are entitled to free repair services.
2. **Limited Warranty :** After the 1-year warranty period expires, LOBOO will offer paid repair services. Charges will be based on the actual material replacement costs, and no additional labor costs will be incurred.
3. **Vibration Damping Structure:** This motorcycle phone holder features a multi-damping structure designed to mitigate substantial and high-frequency vibrations. However, it cannot entirely eliminate vibrations. LOBOO and its authorized dealers are not responsible for phone damage caused by vibrations.

Free warranty services do not cover the following:

- Faults resulting from improper use, intentional damage, self-disassembly, self-modification, self-repair, or damage to provided cables, or faults caused by operating in unsuitable environments.
- Purchases from unauthorized channels or without valid purchase receipts.

Please read the related after-sales service terms thoroughly before unpacking and installing the product. By removing the packaging and installing the product, you are indicating your acceptance of these after-sales service terms.

LOBOO
For My Motour Life

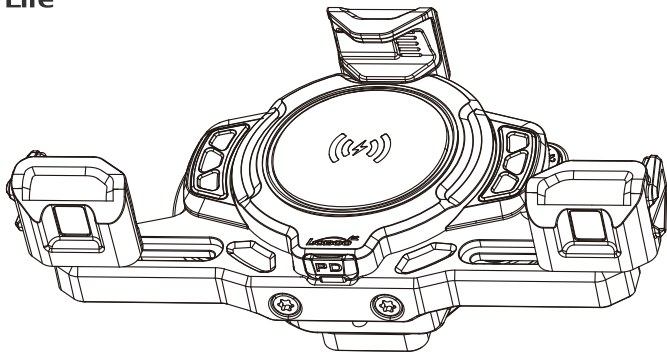

PH02

摩托车手机支架

产品说明书

● 使用前请仔细阅读产品说明书，错误的安装和使用方式会导致手机从手机支架中脱出跌落或损坏手机支架，并失去相关的免费保修服务。

产品规格

型号: PH02

兼容手机尺寸(含手机保护壳)

宽度范围: 65-98mm

长度范围: 125-170mm

厚度范围: ≤ 13 mm

输入电压: 12-16V

无线充电输出功率: 15W(MAX)

有线充电输出功率: 36W(MAX)

保护功能: 反接保护/短路保护/过压保护/过流保护/过充保护/欠压保护/过温保护/异物检测保护

减振结构: 多重减振

装箱清单

①



数量:1件

13mm款手机支架主体

②

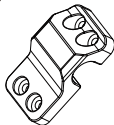

数量:1件

13mm管径卡箍

③

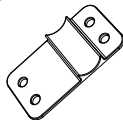

数量:1件

卡箍衬垫

④



数量:4件

M4×18

⑤



数量:1件

3mm内六角扳手

⑥



数量:1件

螺丝胶

⑦

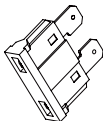

数量:1件

备用保险丝(10A)
(含无线充电模块款)

⑧

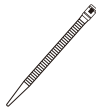

数量:8条

扎线带
(含无线充电模块款)

产品图示

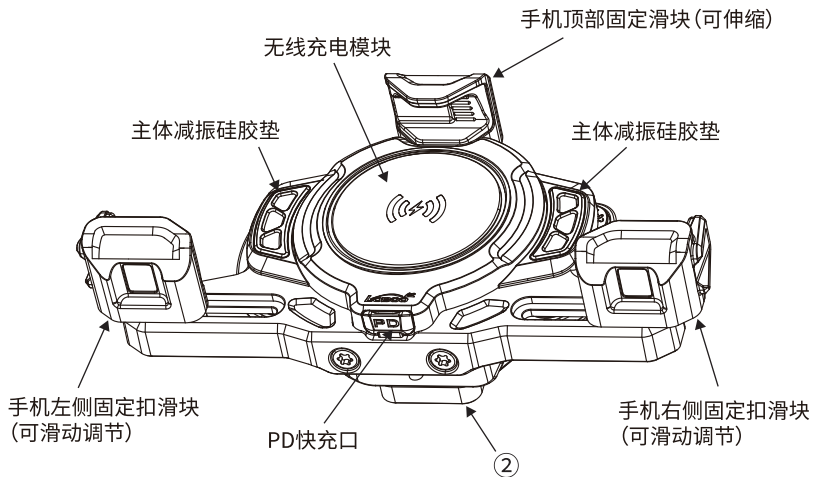

产品图示

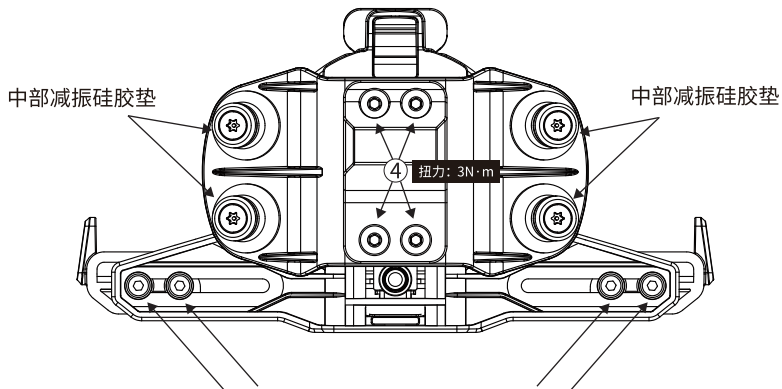

手机左、右侧固定扣滑块调节螺丝
(松开螺丝, 滑动左右滑块至合适位置, 左右滑块位置需居中对称
螺丝扭力1.5N·m, 注意螺牙需涂螺丝胶。)

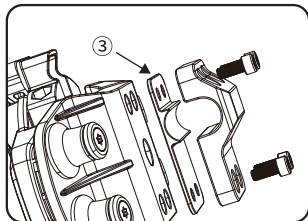

无线充电模块接线图示

保险丝盒

10A

“+”标识、红色接正极

“ACC”标识、黄色接ACC

“-”标识、黑色接负极

ACC是指摩托车上钥匙门打开即通电(长通)、
关闭钥匙门即断电(长断)的12V-15V电线。

安装使用、ACC寻找视频教程



扫码观看视频

安装图示

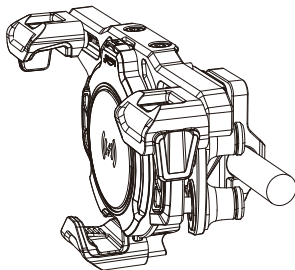
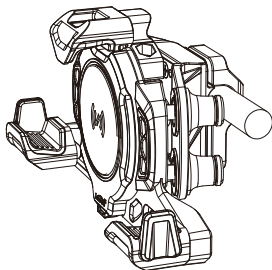

不可倒置安装

使用方法

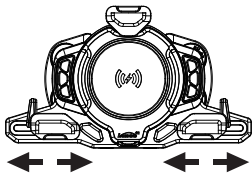

1. 请根据手机尺寸使用配套扳手调整左、右侧固定扣滑块位置(注意调整前需拧下调整螺丝并在螺牙处涂抹螺丝胶, 调整后按扭力要求紧固)。

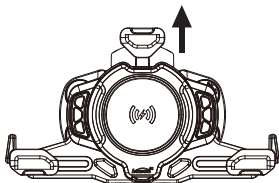

2. 调整完成后拉伸顶部固定扣滑块。

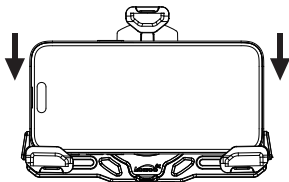

3. 放入手机。

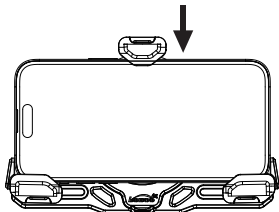

4. 确认左、右侧固定扣滑块贴合手机后松开让顶部固定扣复位紧扣手机。

注意事项

1. 此款摩托车手机支架仅提供日常行车时使用, 严禁过度使用, 如飞跃、竞赛、高强度越野等。
2. 请正确调节左、右侧固定扣滑块位置, 左右固定扣贴合手机间隙不超0.5mm为宜, 错误的调节方式会导致手机从手机支架中脱出跌落。
3. 更换不同型号和尺寸的手机后需重新调节左、右侧固定扣滑块及顶部固定扣。
4. 定期检查所有螺丝, 如有松动, 请及时紧固。
5. 请定期检查顶部滑块顺畅度, 以防灰尘或其它异物堆积导致滑块卡滞, 如有上述情况, 请拆除顶部滑块螺杆并清洁(包括孔道), 并在螺杆表面和胶圈处适量涂抹润滑油、螺牙处涂抹螺丝胶后装回, 螺杆扭力: $1\text{N}\cdot\text{m}$ 。
6. 为保证最佳的无线充电效果, 请在放置手机时尽量让手机背部紧贴手机支架, 并使用尽量薄的手机保护壳, 手机背部离无线充电模块越远, 充电效率越低, 最远不得超过约3mm。
7. 请勿使用背部含有金属部件的手机保护壳, 否则会引发无线充电模块的异物检测保护功能, 从而停止充电。
8. 安装手机支架线缆时, 布线藏线请避开车辆点火线圈和高压包, 以避免电磁干扰可能造成无线充使用异常。
9. 智能手机自带智能温控系统, 当外部环境温度过高、阳光直射、手机散热不良或充电功率过大而导致手机充电温度过高时, 手机无线充会自动降低充电功率, 特别是苹果手机智能温控温度较低, 当手机温度升高时会表现为充电速度变慢, 甚至边充电边掉电的情况, 需等到手机温度降低后充电才能恢复正常, 如需快速充电请使用手机支架有线充电功能。
10. 带充电功能的手机支架仅限安装于12-16V直流电压的燃油摩托车上, 请勿超范围使用。
11. 当不使用有线充电时, 请保持充电口硅胶塞为关闭状态。

售后服务条款

1. 1年免费保修期,此款摩托车手机支架自售出之日起1年内,在正常使用情况下出现质量问题,可享受免费维修服务。
2. 有限保修:一年保修时间到期后,LOBOO将提供有偿保修服务,费用以实际更换材料费用为准,不另收取人工费用。
3. 此款摩托车手机支架为多重减振结构,此减振结构能够减缓大幅度及高频的振动,但仍不能完全消除振动,LOBOO及旗下经销商不对振动造成的手机损坏负责。

免费保修服务不包括以下内容:

- 因使用不当、人为损坏、自行拆解、自行改装和维修、破坏出厂提供的线缆、不合适的操作环境导致的故障。
- 非正规渠道购买或不能提供购买凭证。

使用前请仔细阅读相关售后服务条款,拆除包装并安装即表示接受此售后服务条款。

128G双面铜版纸，骑马钉印刷，英文在前，
中文在后，单页尺寸135*100mm
料号：6.3.08002.090.03